

FOUNDATION PLAN
 SCALE: 1/4" = 1'-0"
 NOTE: REFERENCE FRAMING PLANS FOR ALL FLUSH BEAMS AND POSTS.

NOTE: ALL STEEL COLUMNS TO BE INSTALLED TO THE TOP OF THE CONCRETE SLAB. ALL STEEL BEAMS TO BE INSTALLED TO THE TOP OF THE CONCRETE SLAB. ALL STEEL BEAMS TO BE INSTALLED TO THE TOP OF THE CONCRETE SLAB.

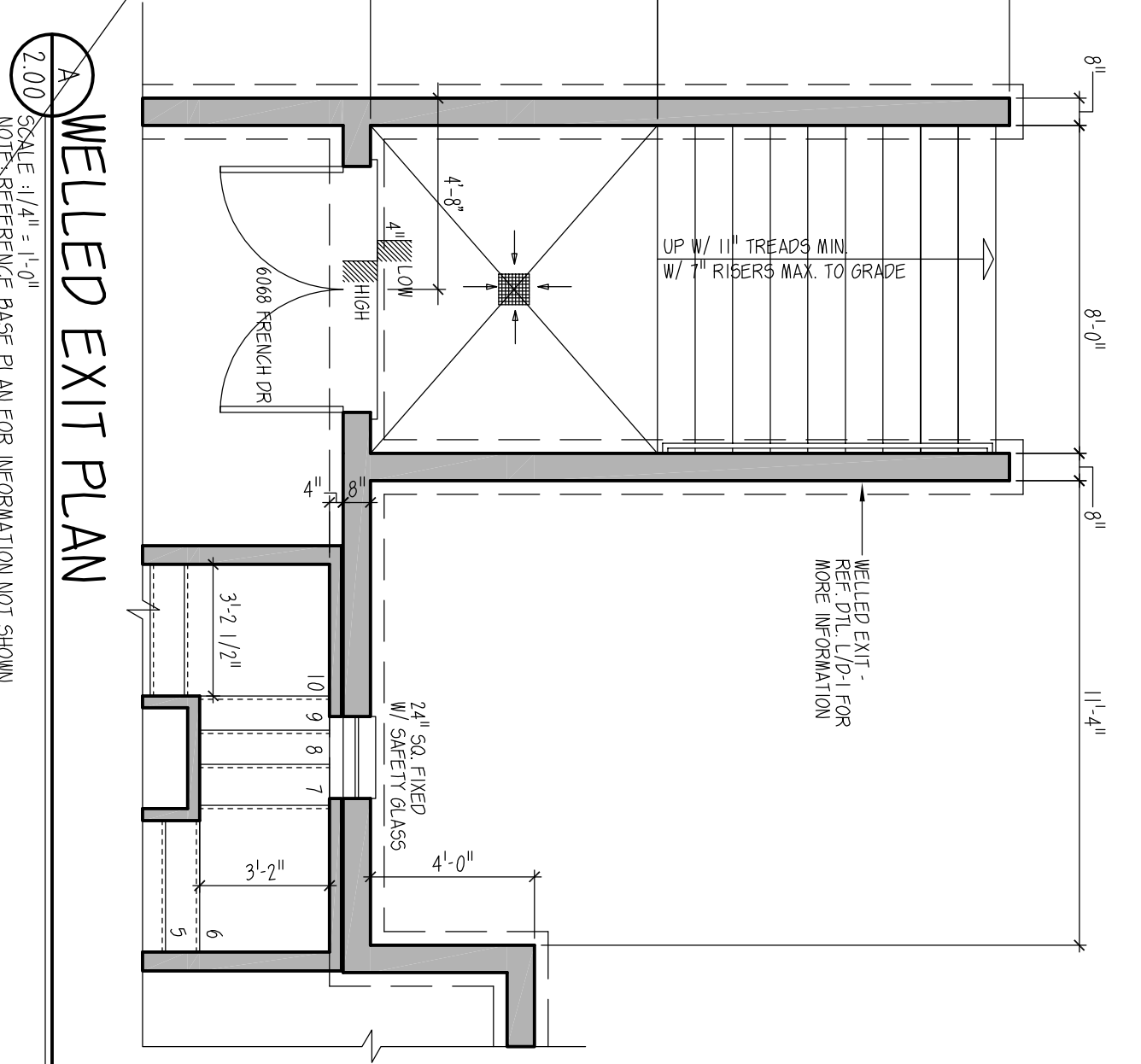

- Foundation Notes**
 IMPORTANT - PLEASE READ BEFORE CONSTRUCTION
1. FLOOR SYSTEM SHALL BE INSTALLED BEFORE FOUNDATION IS SOFT-SEALED.
 2. REVISIONS TO THIS PLAN SHALL BE IN ACCORDANCE WITH 2008 IRC.
 3. HOUSE SHALL BE BUILT IN ACCORDANCE WITH 2008 IRC.
 4. ALL WORK SHALL BE DONE IN ACCORDANCE WITH THE LATEST EDITIONS OF THE INTERNATIONAL RESIDENTIAL CODE BOOKS.
 5. ALL WORK SHALL BE DONE IN ACCORDANCE WITH THE LATEST EDITIONS OF THE INTERNATIONAL BUILDING CODES.
 6. ALL WORK SHALL BE DONE IN ACCORDANCE WITH THE LATEST EDITIONS OF THE INTERNATIONAL PLUMBING AND MECHANICAL CODES.
 7. ALL WORK SHALL BE DONE IN ACCORDANCE WITH THE LATEST EDITIONS OF THE INTERNATIONAL ELECTRICAL CODE.
 8. ALL WORK SHALL BE DONE IN ACCORDANCE WITH THE LATEST EDITIONS OF THE INTERNATIONAL MECHANICAL AND PLUMBING ENGINEERING EXAMINERS BOARD (IMPEB) CODES.
 9. ALL WORK SHALL BE DONE IN ACCORDANCE WITH THE LATEST EDITIONS OF THE INTERNATIONAL MECHANICAL AND PLUMBING ENGINEERING EXAMINERS BOARD (IMPEB) CODES.
 10. ALL WORK SHALL BE DONE IN ACCORDANCE WITH THE LATEST EDITIONS OF THE INTERNATIONAL MECHANICAL AND PLUMBING ENGINEERING EXAMINERS BOARD (IMPEB) CODES.
 11. ALL WORK SHALL BE DONE IN ACCORDANCE WITH THE LATEST EDITIONS OF THE INTERNATIONAL MECHANICAL AND PLUMBING ENGINEERING EXAMINERS BOARD (IMPEB) CODES.
 12. ALL WORK SHALL BE DONE IN ACCORDANCE WITH THE LATEST EDITIONS OF THE INTERNATIONAL MECHANICAL AND PLUMBING ENGINEERING EXAMINERS BOARD (IMPEB) CODES.
 13. ALL WORK SHALL BE DONE IN ACCORDANCE WITH THE LATEST EDITIONS OF THE INTERNATIONAL MECHANICAL AND PLUMBING ENGINEERING EXAMINERS BOARD (IMPEB) CODES.
 14. ALL WORK SHALL BE DONE IN ACCORDANCE WITH THE LATEST EDITIONS OF THE INTERNATIONAL MECHANICAL AND PLUMBING ENGINEERING EXAMINERS BOARD (IMPEB) CODES.
 15. ALL WORK SHALL BE DONE IN ACCORDANCE WITH THE LATEST EDITIONS OF THE INTERNATIONAL MECHANICAL AND PLUMBING ENGINEERING EXAMINERS BOARD (IMPEB) CODES.